

Important Notice

Prior to carrying out any installation, you should refer to our website in order to confirm that this guide is current and still applicable

Safe Handling Procedure

Blok 'N' Mesh recommend that our products are handled and installed by a minimum of 2 people. Wherever possible, manual handling of the product should be avoided by the use of mechanical lifting equipment. It is essential that every load is assessed prior to lifting to reduce the risk of injury. All manual handling should be carried out in accordance with The Manual Handling Regulations 1992 and later requirements.

Product Components

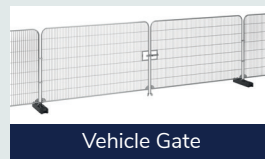

Installation Process

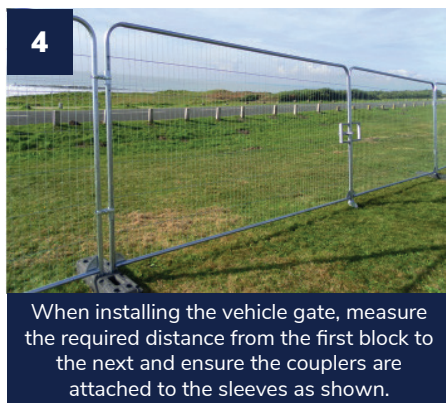
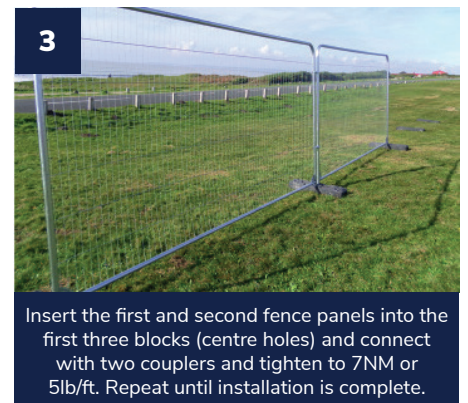
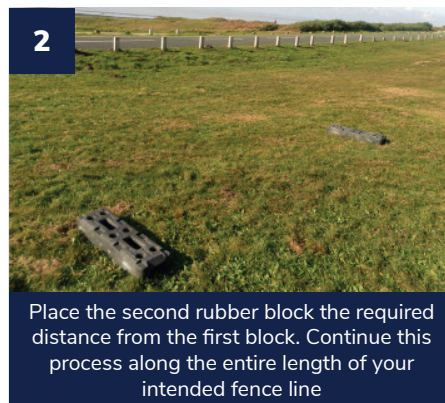

It is the clients responsibility to ensure that the installation is fully checked on a regular basis, particularly after high winds or severe weather conditions, paying particular attention to the security of fixings used within the installation.

Updated September 2020.

Blok 'N' Mesh is not liable for any 3rd party installations. This installation guide is a guide only. We strongly recommend that a full risk assessment and method statement should be carried out prior to installation.

Blok 'N' Mesh Global Ltd (12462123) and Blok 'N' Mesh Europe Ltd (12462239) Leytonstone House, 3 Hanbury Drive, Leytonstone, London, England, E11 1GA

Optional Components



50kg BraceBlok™



Lifting Tool



Anti-Lift Device

Installation Process: 50kg BraceBlok™



1

The 50kg brace block should be used with the short mesh brace. As with standard short mesh brace installation, insert brace through rectangular hole.



2

Using the lifting tool as shown, place brace block on the rubber block. Repeat along entire length of intended fence line.



3

Install fence panels and connect short mesh brace as before until installation is complete.

Installation Process: Anti-Lift Device



1

As with the short mesh brace, anti lift devices are installed at the same stage and in a similar manner. Place the anti lift device under the end of the rubber block as shown.



2

Continue installation until you reach step 3, where a panel should now be placed in the front hole. Now remove nut and plate from bottom coupler and pass bolt through anti lift device as shown.



3

Re-attach coupler plate and nut and tighten (recommended torque 7NM or 5lb/ft) to secure anti lift device. Repeat along fence line until installation is complete.